

NOTE: If you are using a short window support bar or no support bar is required under the window then you must use DPC under the window sill. **OPTION 1:** It is acceptable to have both the DPC and support bar installed together. See below.

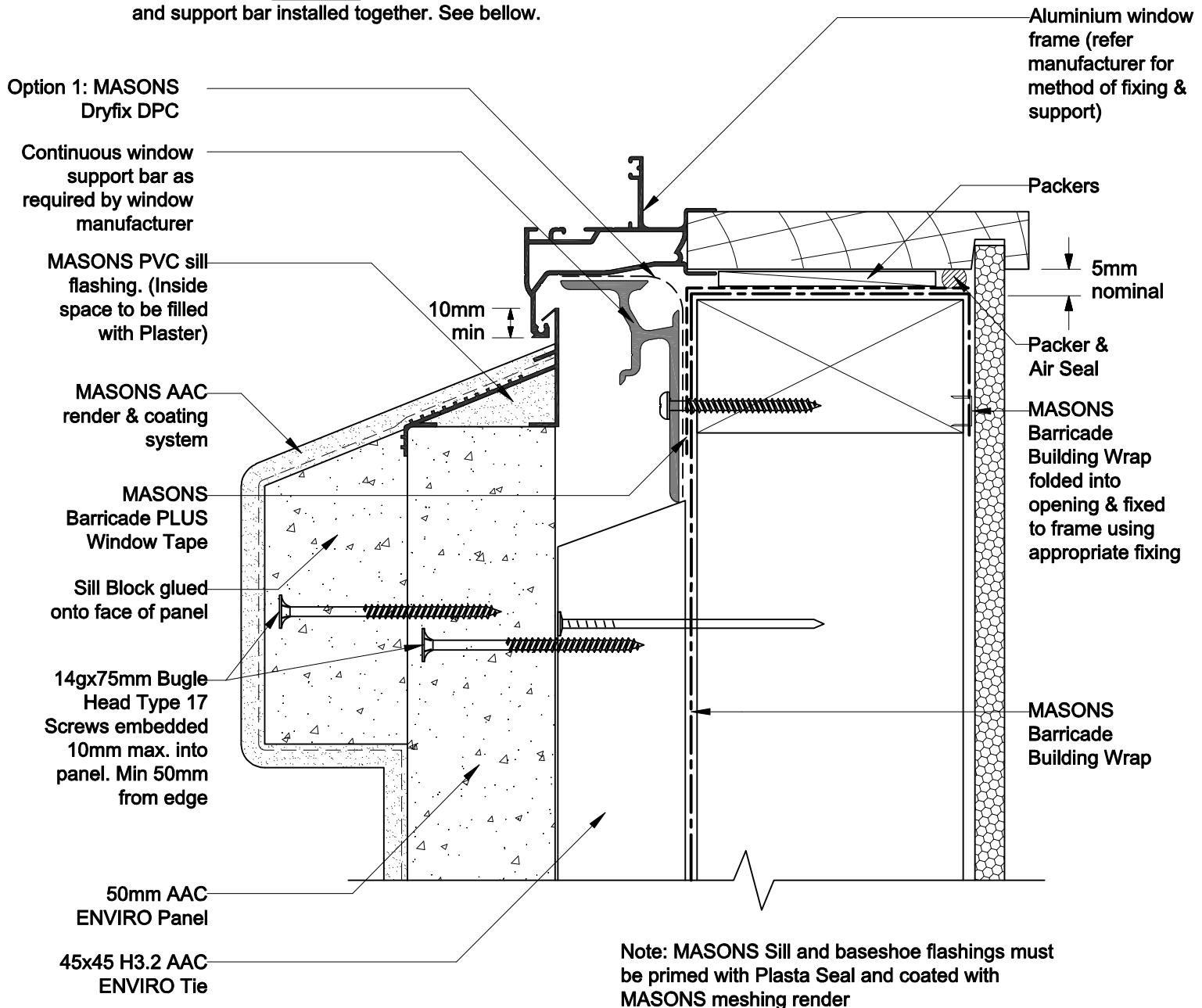

OPENING FLASHINGS Alternative Window Sill

Detail 48 Scale 1:2

MASON'S ENVIRO AAC ON 45mm CAVITY TIMBER FRAME